

# TioBromide®

How to take TioBromide® with medical device

The permitted actuation number of medical device is **180 times**.

Depending on the daily consumption, the permitted period of using the inhaler is from **three months (two times a day) to six months (once a day)**.

## The device is including the following sections:

- 1.Cap
- 2.Mouthpiece
- 3.Flange
- 4.Piercing Buttons

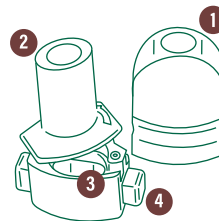
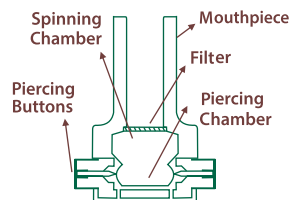

## How to use:

1.Pull off the cap.

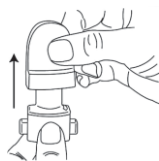

2.Hold the base firmly and turn the mouthpiece in the direction of the arrow (anti-clockwise). This opens the capsule chamber.



3.Remove one capsule out of the blister strip and place it into the capsule chamber:

- .Make sure your fingers are completely dry.
- .Only remove a capsule from the blister pack when you are ready to use it.
- .Do not put the capsule into the mouthpiece.

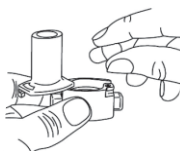

4.Close the capsule chamber by turning the mouthpiece back until you hear a "click".



5.To release the powder from the capsule:

- .Hold the device in the upright position with the mouthpiece pointing up.
- .Pierce the capsule by firmly pressing together both side buttons at the same time. Then release the buttons. Do this only once.
- .If the buttons get stuck then gently pull them back into their starting position with the help of the "winglets". The capsule may break up when you do this and small pieces of capsule might get into your mouth or throat.



6.Breathe out, away from the inhaler, as much as possible.



7.To breathe your medicine deeply into your airways:

- .Place the mouthpiece in your mouth and tilt your head slightly backwards. Close your lips firmly around the mouthpiece.
- .Breathe in rapidly but steadily and as deeply as you can.
- .You should hear a whirring noise as the capsule spins around in the space above the capsule chamber. If you do not hear this noise, open the capsule chamber (see step 2) and check that the capsule lies loose in the capsule chamber.
- .Do not try to loosen the capsule by repeatedly pressing the side buttons.If the capsule is jammed then turn the open capsule chamber upside down and gently tap the bottom. Then repeat step 7.
- .You will have a sweet taste in your mouth from the lactose and you may feel powder at the back of your throat. This is normal.



8.After breathing in:

- .Hold your breath for as long as you comfortably can while taking the inhaler from your mouth.
- .Then breathe out through your nose.
- .Open the capsule chamber to see if there is any powder left in the capsule. If there is, repeat steps 6 to 8.

9.After you have used up all the powder, open the capsule chamber (see step2).

- .Remove the empty capsule and use a dry tissue or soft brush to remove any powder left inside.
- .**Do not use water to clean the inhaler device.**

10.Close the capsule chamber and place the cap.

## Reporting of side effects

If you get any side effects, talk to your doctor or pharmacist. This includes any possible side effects not listed in this leaflet.

You can also report side effects directly to the pharmacovigilance department of Ofogh Darou via :

Email: [info@ofoghpharma.com](mailto:info@ofoghpharma.com)

Tel: + 982189332000

Website: [www.ofoghpharma.com](http://www.ofoghpharma.com)

By reporting side effects, you can help provide more information on the safety of this medicine.

**Marketing/ Manufacturer/ Authorisation Holder:**

**Ofogh Darou co.**

**Ofogh Darou Blvd, Kaveh Industrial City, Iran.**

